

Christian Schreiber

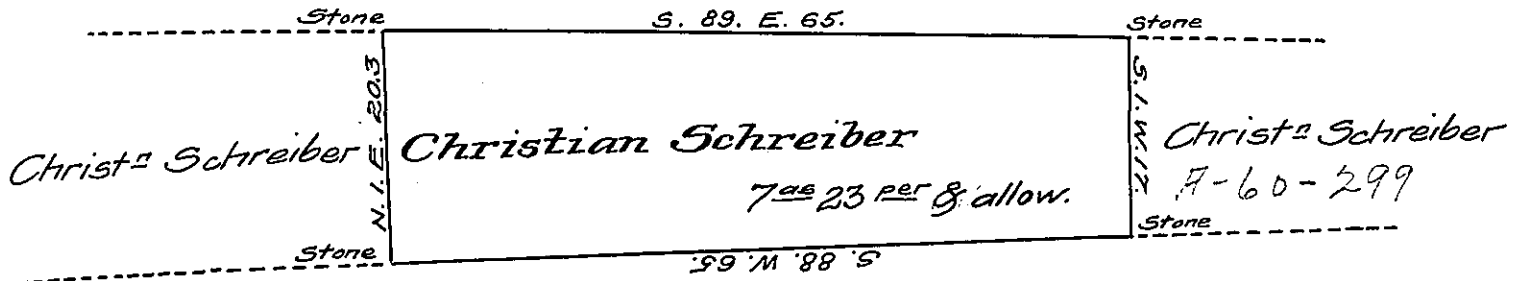

Heirs of Philip Kuntzelman & others.

The above described tract of land Situate in Hegins Town-  
 ship Schuylkill County, Containing Seven Acres & twenty three perches  
 of land & the Usual Allow. &c. Surveyed the 7<sup>th</sup> day of April A.D. 1857  
 by Virtue of a Warrant dated the 27<sup>th</sup> day of January A.D. 1857.  
 Granted to Christian Schreiber. (Unimproved land.)

by Valentine Savage, for  
 Tobias Kreider, Surveyor  
 for Schuylkill County.

I approve of the above Survey made by Valentine Savage  
 Esqr. Given under my hand County Surveyors Office, Pine Grove,  
 Schuylkill County, now I make return of the same this 18<sup>th</sup> day  
 of Nov<sup>r</sup> A.D. 1858.

To John Rowe Esqr.  
 Surveyor General  
 of Pennsylvania.

Tobias Kreider  
 County Surveyor

IN TESTIMONY that the above is a copy of the original remaining on file in  
 the Department of Internal Affairs of Pennsylvania, made  
 conformably to an Act of Assembly approved the 16th day of  
 February, 1833, I have hereunto set my Hand and caused  
 the Seal of said Department to be affixed at Harrisburg,  
 this twenty eighth day of February 1908.

*Henry Howard*  
 Secretary of Internal Affairs.